



Edition : 1.0
Date: (03/26)

Instruction Manual

DRIP TRAY TO SUIT ENGINE STANDS ESĐT-16

Order Code: (A338)

BEFORE ASSEMBLING

Please read this instruction manual before assembly.



CAUTION

Before assembly please pay attention to the following points in priority;

Confirmation of components: Before assembling, please confirm all parts arrived and are in good order.

Site for assembly: Please assemble it on the soft floor such as smooth carpet and flannel blanket. When you assemble on wooden floor, please put thin towels on the floor.

Points for attention when assembling: Please wear gloves to ensure that it can be assembled safely, and use two persons to help in the assembly process.

SAFETY INFORMATION

1. Insert the drip tray securely into the base of the recommended engine stand.
2. Always operate on flat, level ground – engine stands are not fitted with brake wheels.
3. Ensure the drain plug is properly inserted before use.
4. Collect and empty oil into an approved container suitable for recycling.
5. Clean up any waste or spills thoroughly to maintain a safe and tidy work area.



CAUTION: Do not attach or mount this product to a vehicle. This may cause personal injury or product damage. Mounting this product to any vehicle in any manner will void warranty.



CAUTION: Keep the product on level surfaces. The product may become unstable and tip if stored or moved on an un-level surface, which may cause personal injury or product damage.



CAUTION: Do not stand on this product. You may fall which may cause personal injury or product damage.



CAUTION: Collect and empty oil into an approved container suitable for recycling. Replace drain plug when finished.

SUITS ENGINE STANDS:

- HES-907F
- ESR-450W



ASSEMBLY INSTRUCTIONS

TOOLS & ASSISTANCE NEEDED

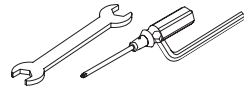

Hex Key, Spanner and a
Philips Head Screwdriver

*Tools not included

STEP 1.

Inserting the Drain Plug

- Fit the washer into position.
- Insert the drain plug as shown below and ensure it is seated correctly.

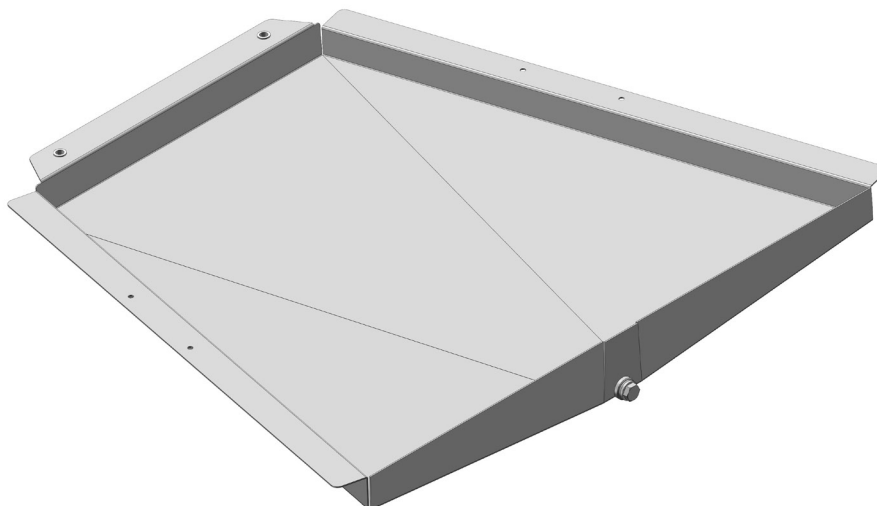
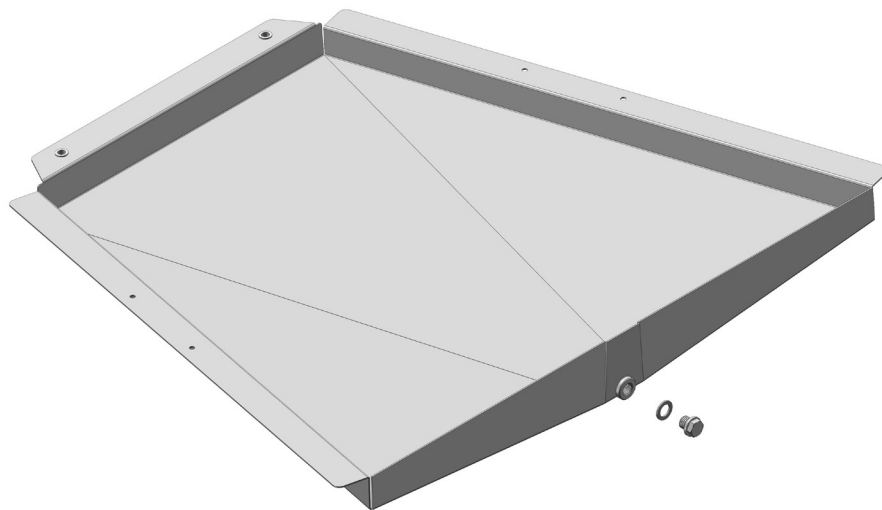

STEP 2.**Attaching the Handles**

- Position the 2 handles as shown below.
- Secure each handle using the 4 supplied screws and tighten firmly.

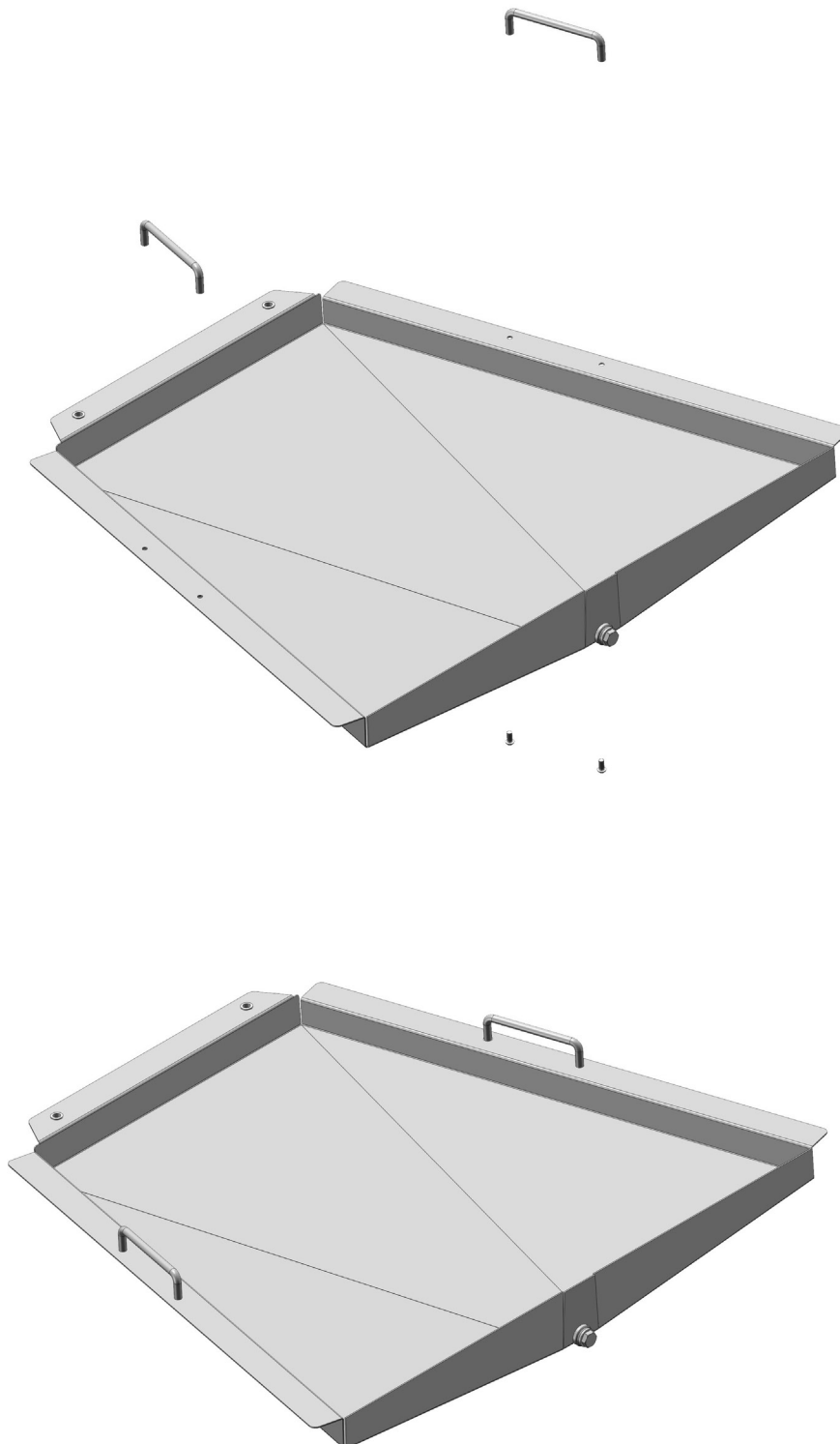

STEP 3.**Attaching the Felt Pads**

- Position and firmly stick the 6 felt pads in place as shown below.

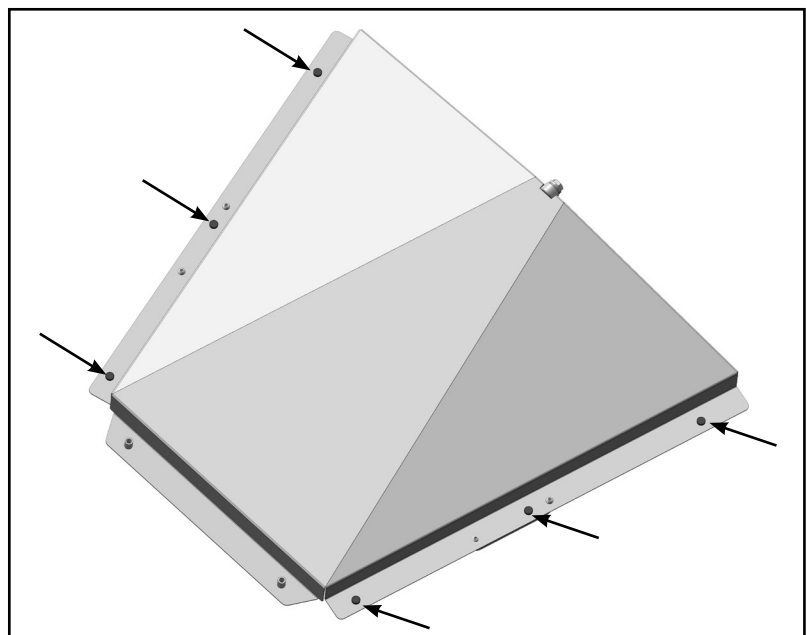
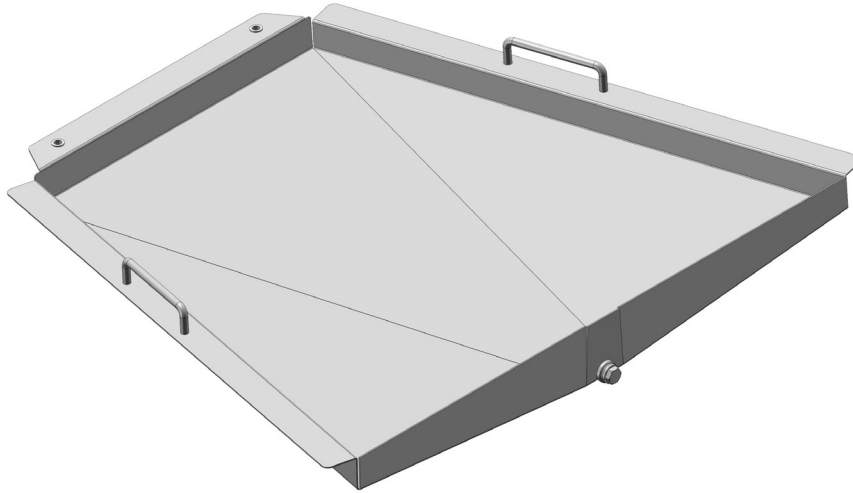

STEP 4.**Attaching the Connecting Brackets**

- Assemble the connecting brackets onto the ends of the drip tray using the supplied bolts and washers (as shown below).
- Leave the bolts slightly loose to allow for easier fitting to the engine stand.

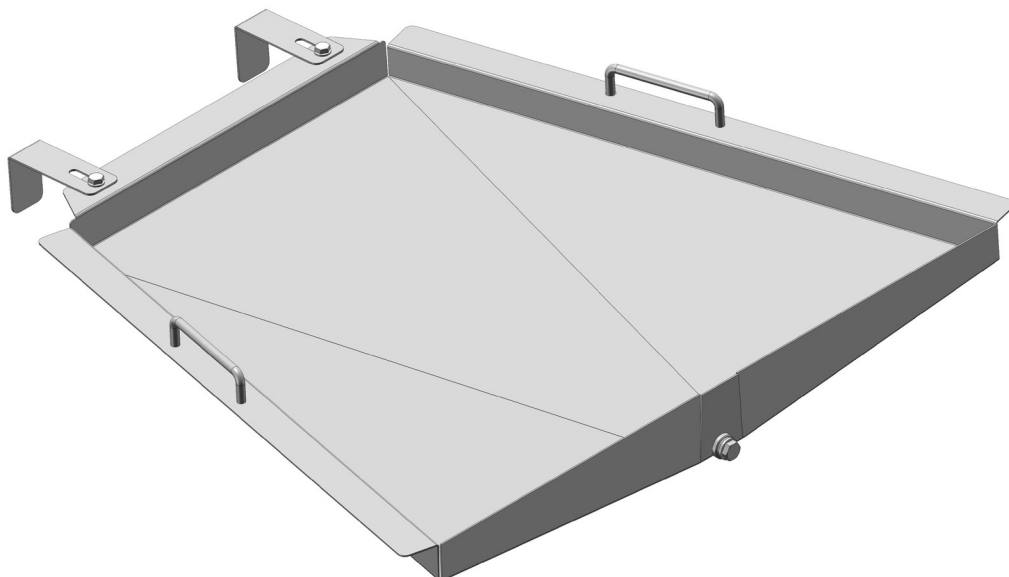
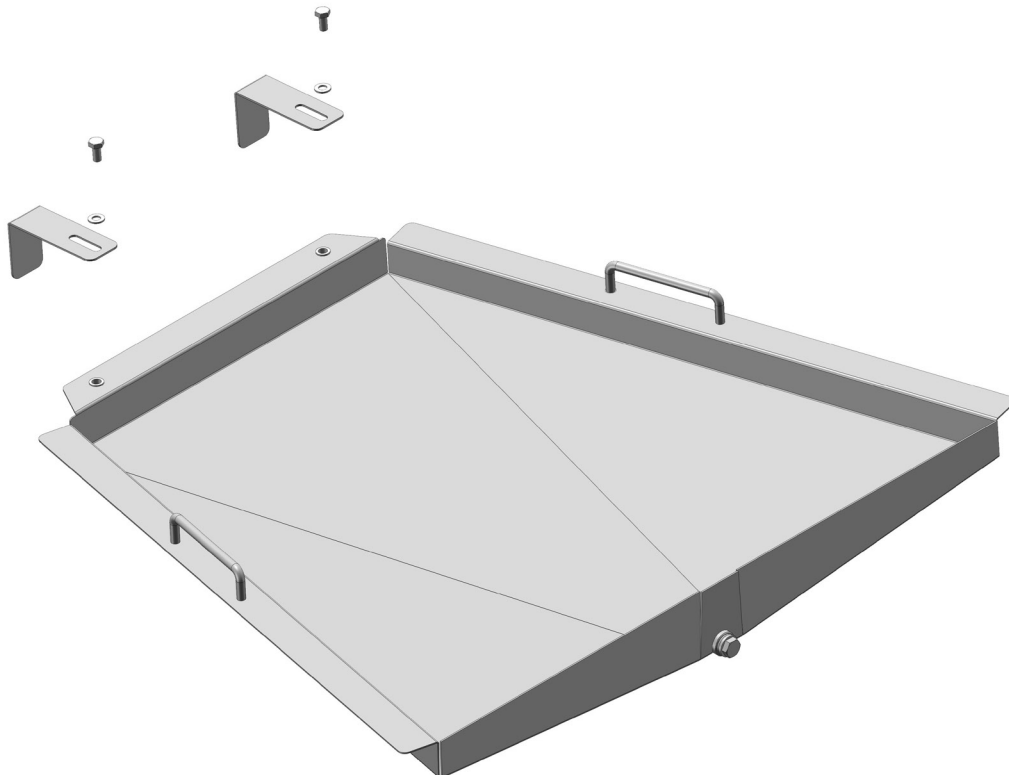

INSTALLING DRIP TRAY TO OPTIONAL ENGINE STANDS

Insert the drip Tray into the base of your Engine Stand

- Carefully insert the drip tray into the engine stand, ensuring the connecting brackets clip securely over the end frame (as shown below).
- Once in position, adjust the connecting brackets so the tray sits firmly.
- Tighten and lock the connecting bracket bolts (A) securely.

SUITS ENGINE STANDS:

- HES-907F
- ESR-450W



ESR-450W



HES-907F

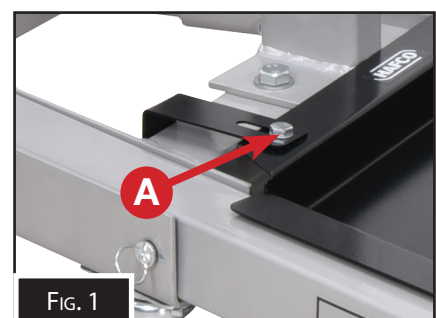

FIG. 1

REMOVING & EMPTYING THE DRIP TRAY

Remove the drip tray when emptying

- Carefully loosen the connecting bracket bolts before lifting the drip tray out of the engine stand.
- Always use two people to safely lift the drip tray out for cleaning.
- Dispose of used oil responsibly in accordance with local regulations and recycling guidelines.
- Thoroughly clean the drip tray before reinstalling it into the engine stand.



ENVIRONMENT PROTECTION

Recycle unwanted materials instead of disposing of them as waste. All tools, accessories and packaging should be sorted, taken to a recycling centre and disposed of in a manner which is compatible with the environment. When the product becomes completely unserviceable and requires disposal, drain any fluids (if applicable) into approved containers and dispose of the product and fluids according to local regulations.

IMPORTED BY

HARE & FORBES
MACHINERYHOUSE

Australian Distributor

Hare & Forbes
Machineryhouse
Sydney - Melbourne
Adelaide - Brisbane - Perth

Ph: 1300 202 200
www.machineryhouse.com.au

MACHINERYHOUSE

New Zealand Distributor

Machineryhouse
Auckland
Christchurch

Ph: 0800 142 326
www.machineryhouse.co.nz